



INSTRUCTION BULLETIN

No. 9004941
Machine: S30, S30 XP,
S30 X4
Published: 04-2008
Rev. 00

NOTE: DO NOT DISCARD the Parts List from the Instruction Bulletin. Place the Parts List in the appropriate place in the machine manual for future reference. Retaining the Parts List will make it easier to reorder individual parts and will save the cost of ordering an entire kit.

NOTE: Numbers in parenthesis () are reference numbers for parts listed in Bill of Materials.

Installation instructions for **kit number 9004940**

SYNOPSIS:

This kit contains the parts needed to install side skirt kit on S30, S30 XP, and S30 X4 machines. Please follow step-by-step instructions.

SPECIAL TOOLS / CONSIDERATIONS: NONE

(Estimated time to complete: 2 hours)

When assembling/disassembling hydraulic components:

1. Thoroughly clean outside of hydraulic components **before** disconnecting hydraulic hoses or fittings to prevent contaminants from entering system.
2. Cap disconnected hoses and open ports to prevent contaminants from entering system.
3. Flush hoses and fittings with air, solvent, or hydraulic fluid to prevent contaminants from entering system.
4. Mark hydraulic hoses with locations of where they are attached. Markings make it easier to reconnect hoses to proper locations.
5. Discard all hydraulic fluid drained from the system. Use only new approved hydraulic fluid to replenish hydraulic reservoir. Hydraulic fluid is potentially dangerous to the environment. Obey all federal, state, and local laws/regulations governing the disposal of environmentally hazardous materials when disposing hydraulic fluid.

PREPARATION:

1. Start the machine and completely raise the main brush.
2. Park the machine on a clean level surface, turn off the machine, remove the key, and set the parking brake.

FOR SAFETY: Before leaving or servicing machine, stop on level surface, turn off machine, and remove key.

3. Open both brush compartment doors.
4. Remove the main brush from the machine. Refer to the Operators Manual for instructions how to remove the main brush.

INSTALLATION:

1. Remove the 40" hydraulic hose from the main brush drive motor and hydraulic control valve port M2. Discard the hose. Refer to Fig. 1.
2. Remove the straight fitting from the main brush drive motor. Discard the straight fitting. Refer to Fig. 1.
3. Tighten the 90° fitting (1) into the main brush drive motor. Refer to Fig. 1.
4. Connect the new 40" hydraulic hose (2) to the 90° fitting installed in the main brush drive motor in the previous step. Refer to Fig. 1.
5. Route the 40" hydraulic hose through the nylon sleeve, to the hydraulic control valve, and connect the hose to the hydraulic control valve port M2, where the discarded 40" hydraulic hose was previously installed. Refer to Fig. 1.

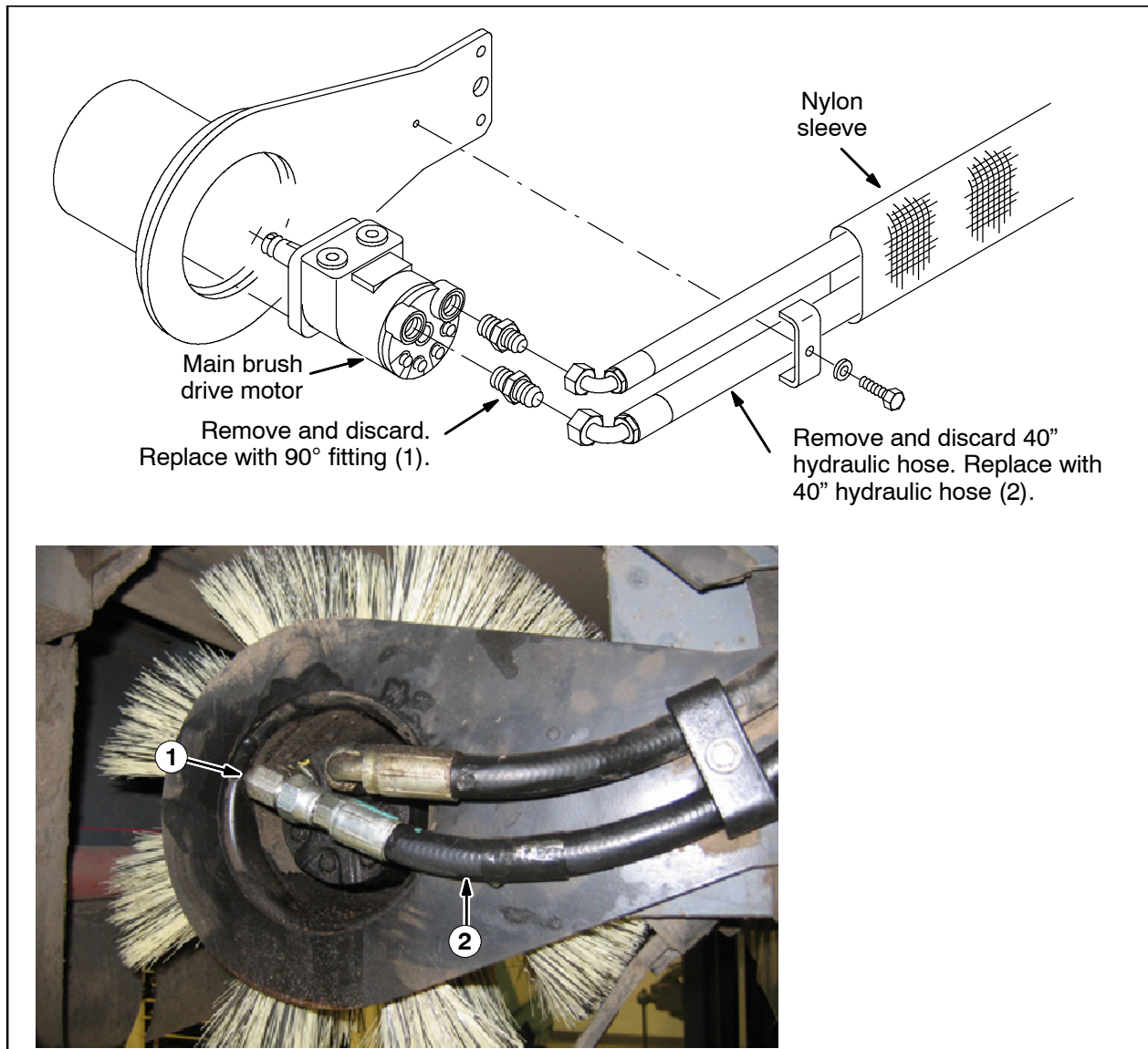

FIG. 1

6. Remove the brush compartment skirt from the machine. Discard the removed skirt and set the mounting hardware and static chain aside. Refer to Fig. 2.

7. Use set aside hardware to install the new brush compartment skirt (6) and the static drag chain onto the machine. Refer to Fig. 2.

8. Adjust the length of the skirt. The skirt should be between 3/16" and 1/4" off the floor.

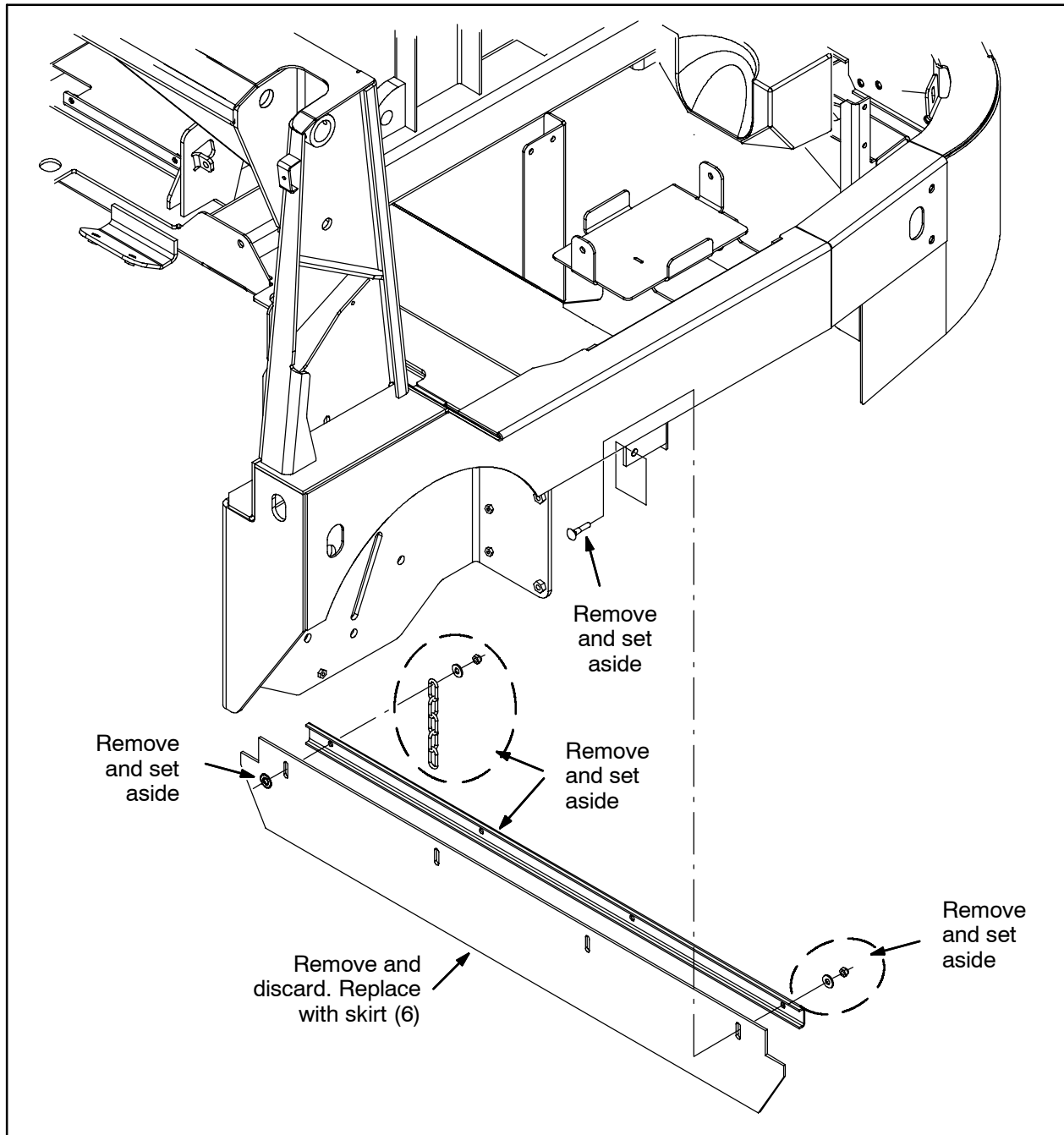

FIG. 2

9. Remove the skirts from both brush compartment side doors. Set the skirt retainers aside. Discard the skirts and the mounting hardware. Refer to Fig. 3.
10. Use four hex screws (7) and four flat washers (8) to install each saved skirt retainer, brush door skirt (3), skirt bracket (4), and brush door skirt (5) onto the brush doors. Refer to Fig. 3.
11. Adjust the length of the skirts. The skirts should be between 1/8" and 3/16" off the floor.
12. Add hydraulic fluid to the system if any fluid was lost when hose and fitting were replaced.
13. Reinstall the main brush.
14. Start and test machine. Check area around new hydraulic hose and fitting for leaks.

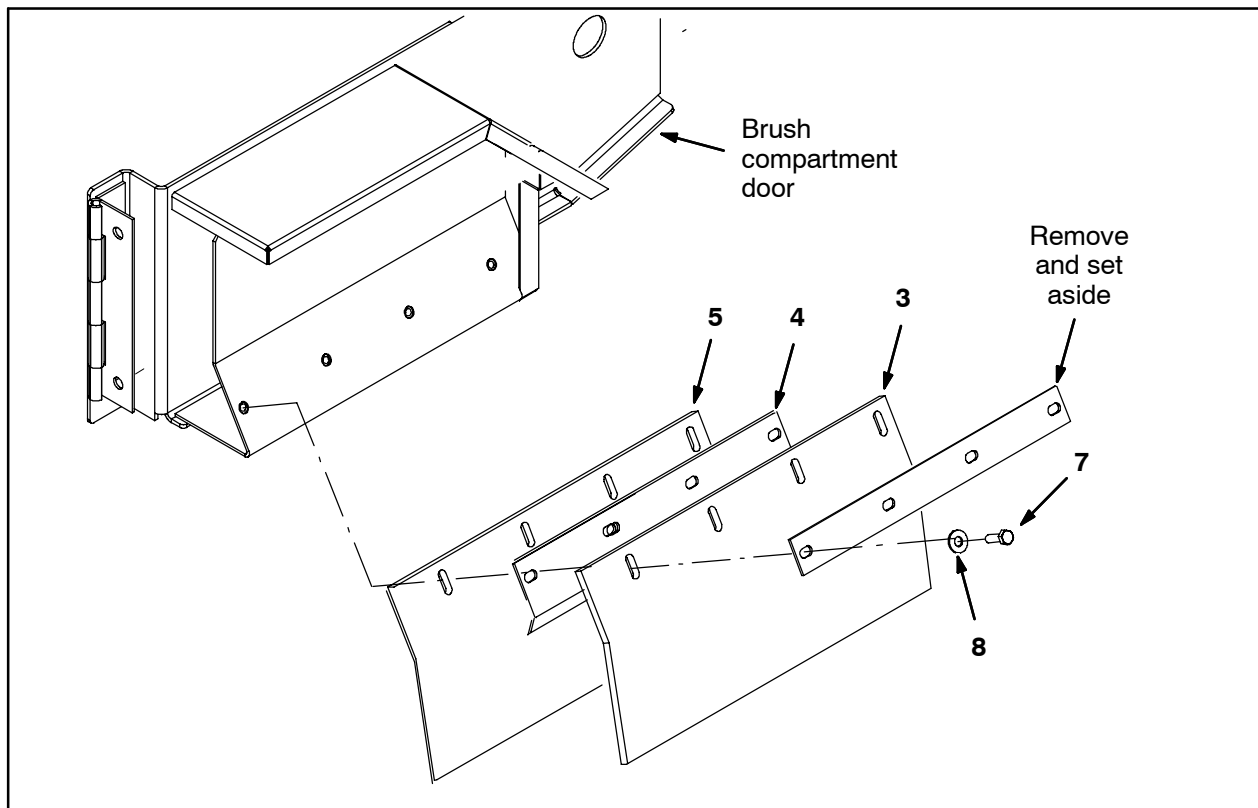

FIG. 3

Bill of Materials for Skirt Kit, Side/Rear [S30]-9004940

Ref.	Tennant Part No.	Description	Qty.
▽	9004940	Skirt Kit, Side, Side/Rear [S30]	1
▲	1 1046890	Fitting, Hyd, E90, JM08/OM08, Med	1
▲	2 365009	Hose, Hyd, TC08, JF08Str/JF08Str, 040.0	1
▲	3 1045366	Skirt, Door, Brush	2
▲	4 1045352	Bracket, Skirt	2
▲	5 1045354	Skirt, Door, Brush	2
▲	6 1045348	Skirt, Neo, 18, 06.74W 50.00L, 04/SL	1
▲	7 76570	Screw, Hex, M8 X 1.25 X 30, 8.8	8
▲	8 32491	Washer, Flat, 0.31, Std	8

TENNANT COMPANY
P. O. Box 1452
Minneapolis, MN 55440-1452